

CESK2 Open Width Knitted Fabric Inspection, Rolling and Metering Machine

Open width tensionless inspection and high speed measuring machine with data collection and analysis system to handle a wide range of rolled materials. This system can be supplied to operate from roll to roll, or with various other fabric input and output options.

- Ergonomically designed
- Fast and easily handled, requires only one operator
- Improves material quality
- Synchronizes production processes
- Provides objective process quality reporting
- Accurately measures rolls
- Reduces administration

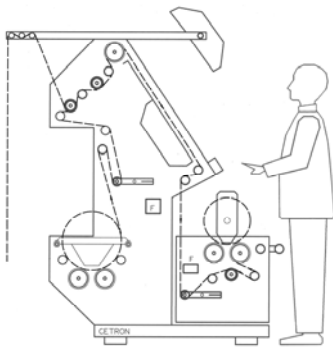

Simple fabric input control

Fabric is unwound through a motor driven roller system for consistent tensionless, relaxed input.

End of roll automatic stop sensor - For next roll joining

This will allow for efficient continuous inspection, from roll to roll.

Full width fabric inspection - With 55 deg. fixed angle inspection screen

Fabric can be examined with the aid of different viewing and lighting options. Ultraviolet lighting is provided for raw fabric inspection.

Accurate fabric length and optional weight measurements

Fabric roll length and weight can be taken using industrial standard measuring systems with digital readouts to give consistent fabric roll assessments.

Accurate fabric edge control

"Photoguide" electronically controlled proportional variable edge correcting system for perfect roll generation.

Consistent roll output - With twin rewind rollers and roll hardness adjustment

Processed rolls are rewound with the minimum amount of tension and are consistent from roll to roll.

Spiral spreading rollers

Uniform rolling by spiral spreading rollers with high speed separate motors.

Auto adjustable tension

Automatic adjustable tension of fabric when rewinding.

Versatile fabric Input and output options - Synchronize with other production operations

Systems are available for different fabric input and output presentations, roll to roll, continuous fabric input, face in/face out, etc. to synchronize with the other operations.

Data collection and analysis system - With fabric fault tagging (optional)

100% fabric inspection with accurate fault logging, barcode tag printing roll length and weight measurement by specially designed system, allowing for accurate fabric roll analysis and printout.

Technical Specifications	
Speed	0 to 50 meters / minute
Fabric width	1.8 - 4.0 meters
Standard roll diameter	50cm
Standard roll weight	50Kg
Overall machine height	220cm
Overall machine width x depth	250 - 450 x 150cm
Overall machine weight	900Kg
Motor Count	5 AC
Electrical requirement	220V - 240V AC 50Hz 3 Phase

Head Office

Factory